

1403 PRINTER MODEL N1

Plan View

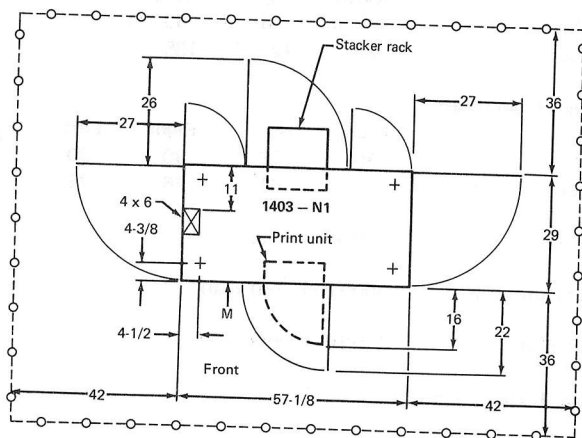

Specifications

Dimensions:

	Width	Depth	Height
Inches	57-1/8	29	53-1/2
Centimeters	145	74	136

Service Clearances:

	Front	Rear	Right	Left
Inches	36	36	42	42
Centimeters	91	91	107	107

Weight: 1250 (570 kg)

Heat Output/hr: 4500 Btu (1130 kcal)

Airflow/min: 350 ft³ (10 m³)

Power Requirements:*

kVA 1.5

Operating Environment:

Temperature	60° to 90° F (16° to 32° C)
Relative humidity	20% to 80%
Maximum wet bulb	78° F (26° C)

Nonoperating Environment:

Temperature	50° to 110° F (10° to 43° C)
Relative humidity	8% to 80%
Maximum wet bulb	80° F (27° C)

* Powered from 5421.

